

Gouvernance

Regierungsführung

3

Méthodes

Methoden

2

Pédagogie

Pädagogik

Digital Transformation of VET

Ziele

Objectifs

1

Inhalt

Contenus

EPFL

<https://www.ouest-france.fr/le-boulangier-philosophe-nous-raconte-le-pain-56936>



Should you baker know data sciences ?







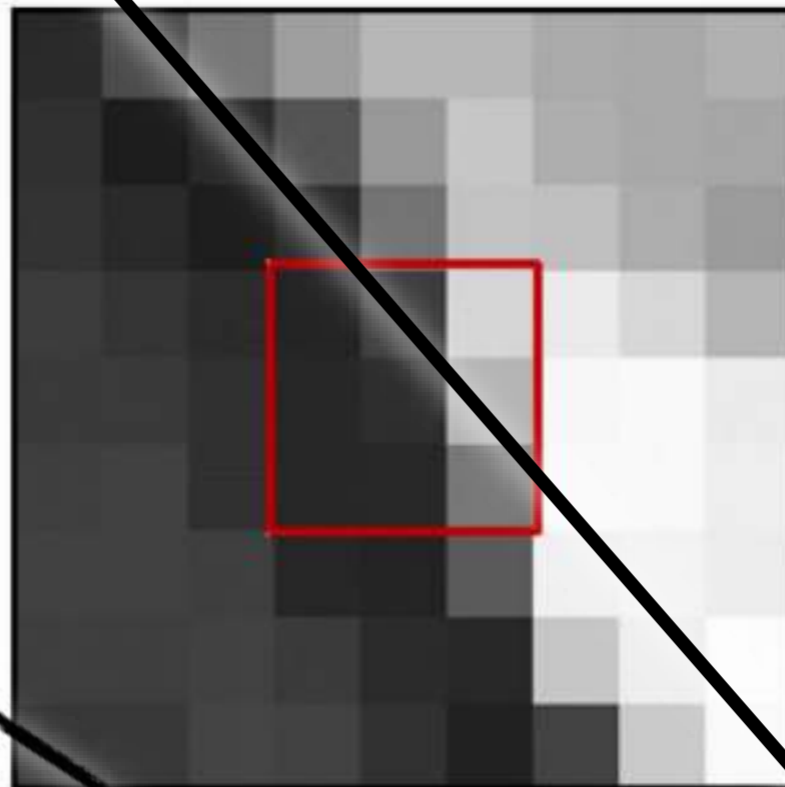
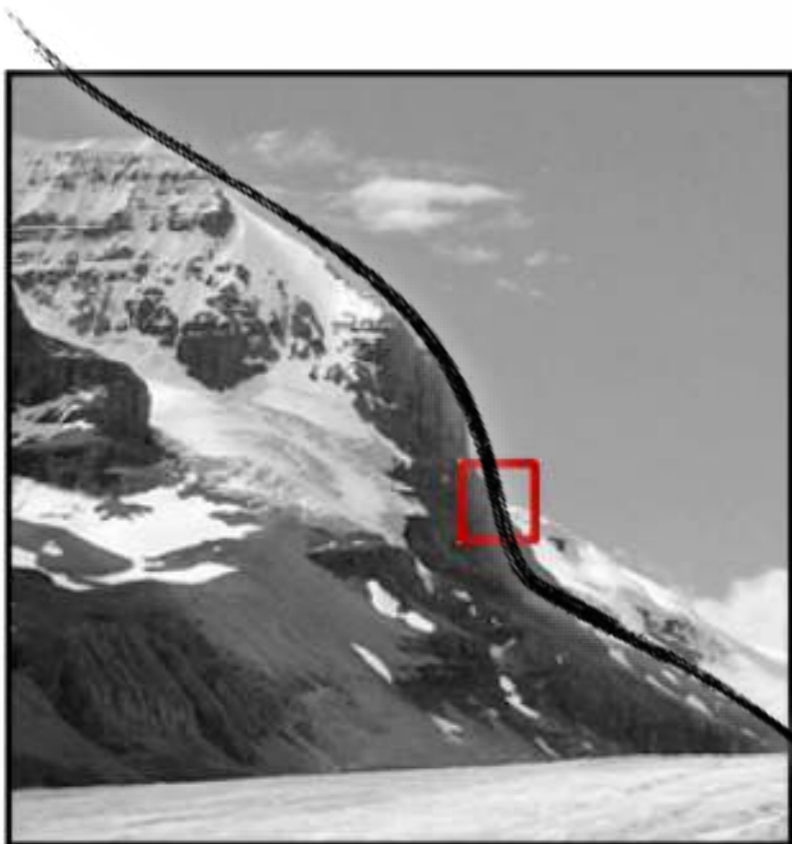

43	102	169
35	58	191
38	44	155





Customer A

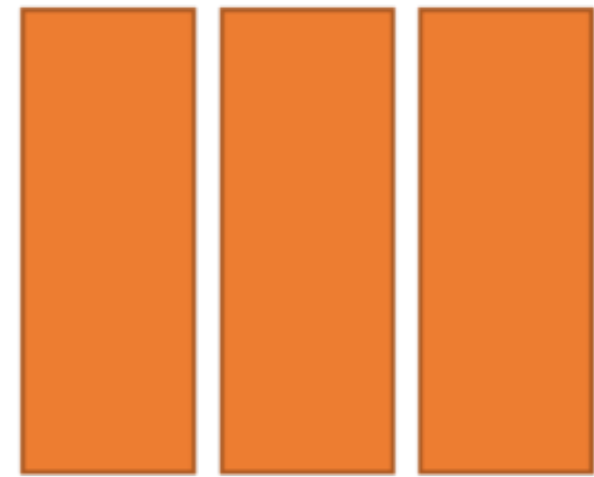

Customer B

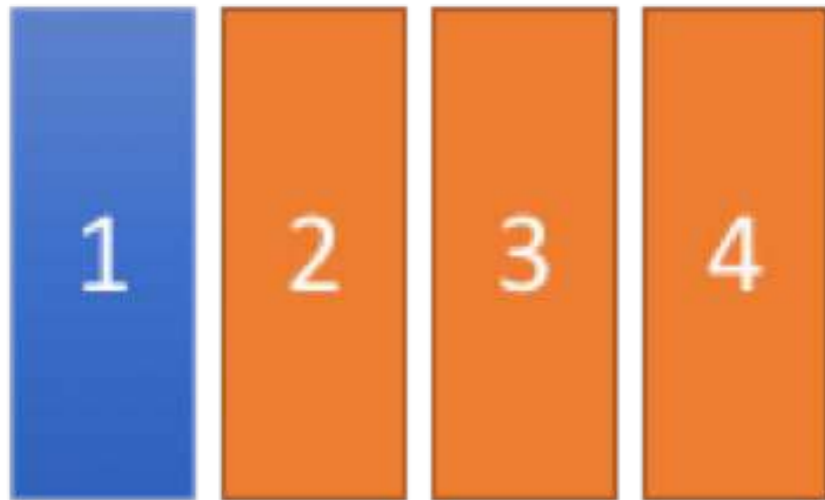

$$1 + 4 = 5$$

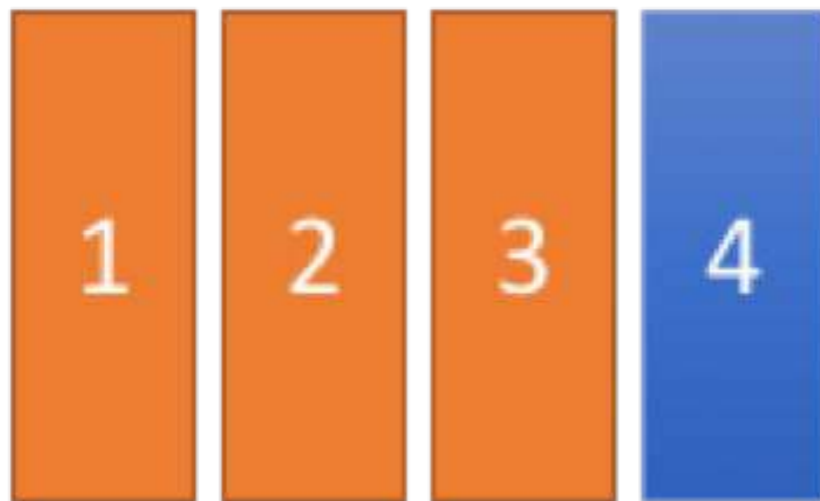

$$3 + 4 = 7$$

Computational Thinking Skills

Décomposer un problème complexe en composantes plus simples, ;

Utiliser des **abstractions** pour représenter le problème ainsi que pour décrire et énumérer les solutions réalisables ;

Identifier des **similarités** parmi les instances de la même classe de problèmes.

Organiser et analyser logiquement les données ;

Reconnaître si l'information est incomplète ou non fiable et donc insuffisante pour la prise de décision et si elle est suffisante pour une **approximation**.

Reformuler le problème en une série d'étapes ordonnées (**algorithme**) avec des éléments tels que l'itération, la représentation symbolique et les opérations logiques.

Traduire l'algorithme en code (**programmation**)

TRANSFERT

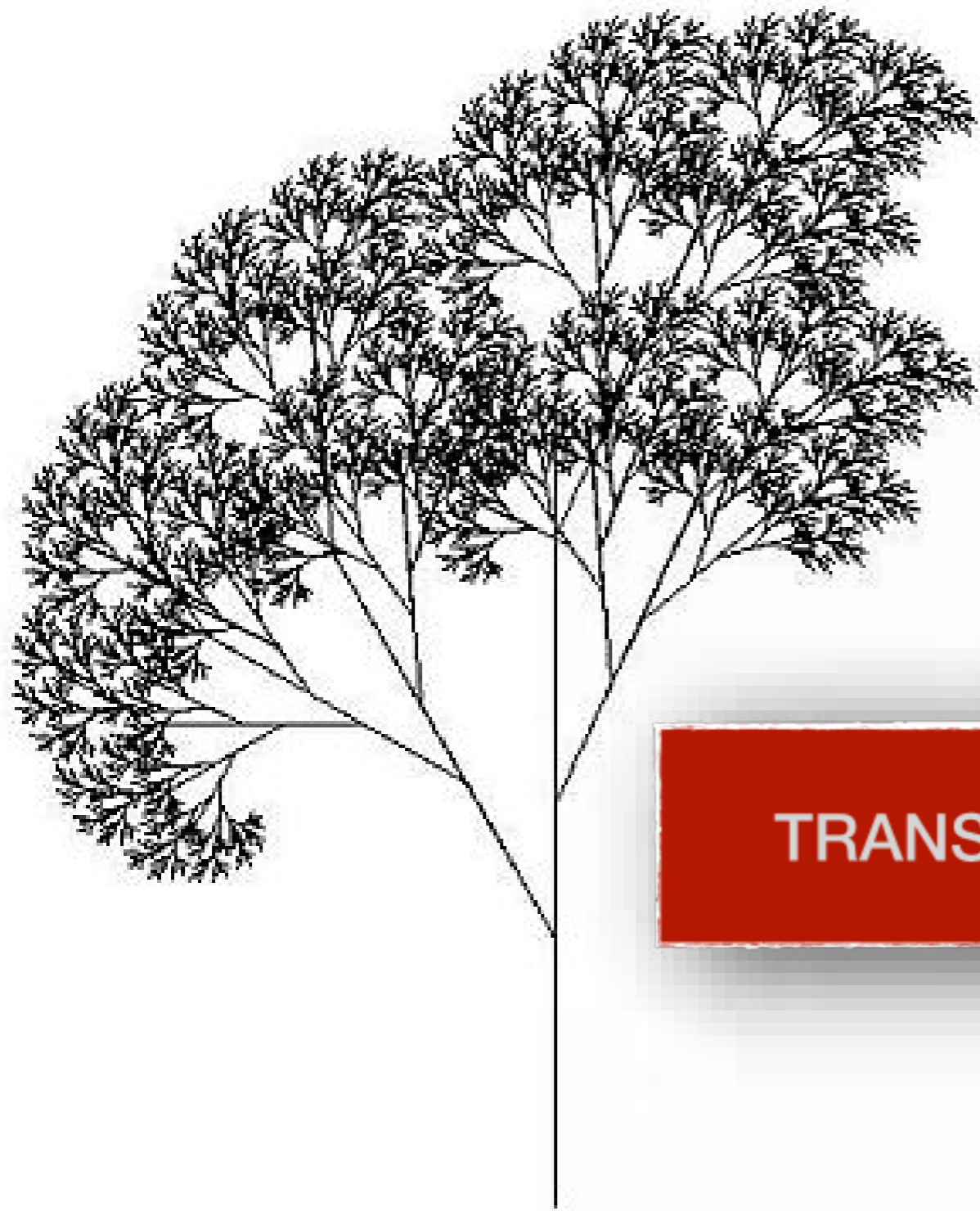

TRANSFERT



Maths

Histoire

Physique

Géographie

Latin

TRANSFERT



Gouvernance

Regierungsführung

3

Méthodes

Methoden

2

Pédagogie

Pädagogik

Ziele

Objectifs

1

Inhalt

Contenus

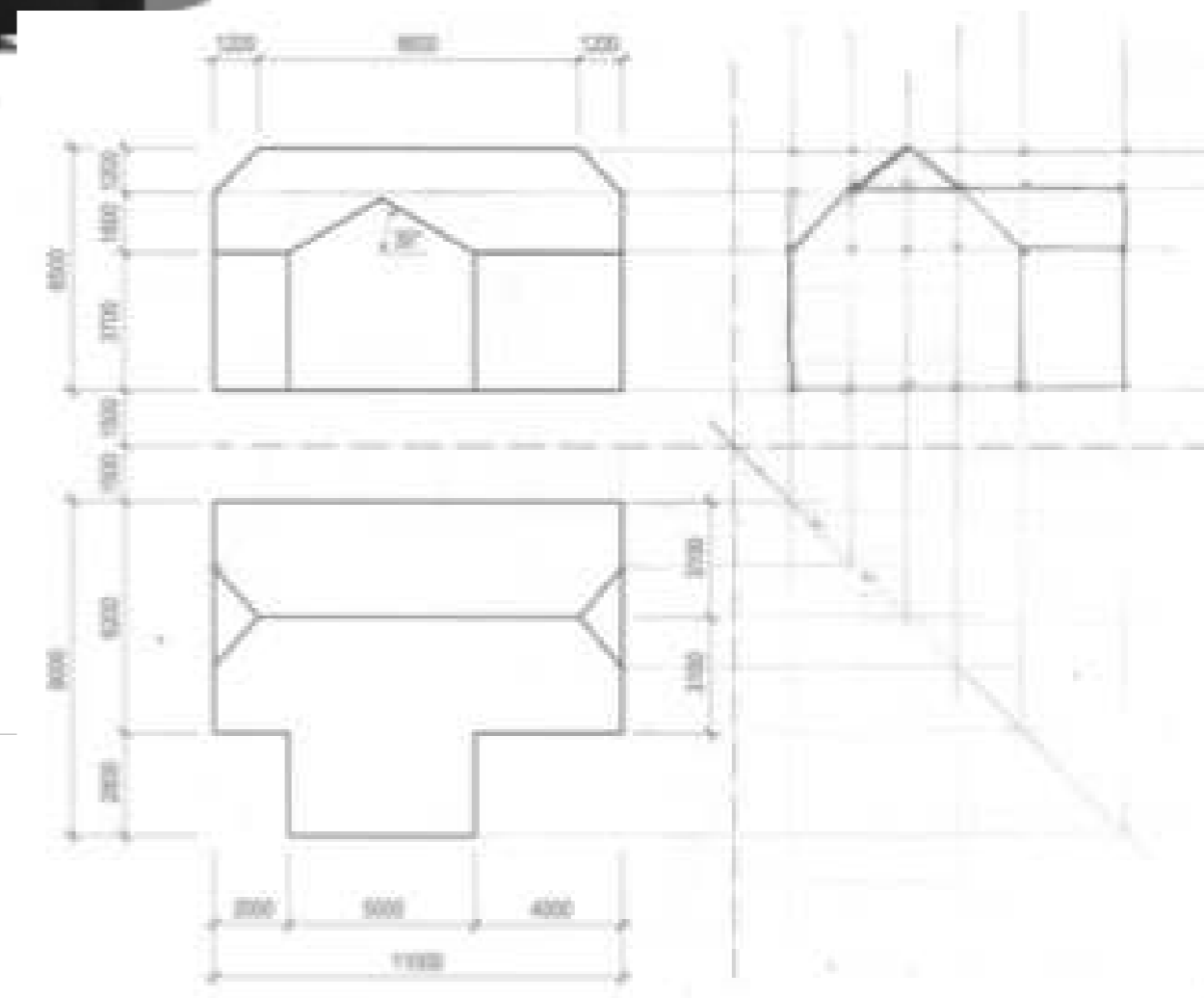

Realto-à propos - REALTO L... x

about.realto.ch/language/fr/

En savoir plus sur Realto Questions fréquentes

Realto

REALTO - LA PLATE-FORME POUR LA FORMATION PROFESSIONNELLE CONNECTÉE

FONCTIONALITÉS LOGIN



<https://www.realto.ch/>



PIERRE DILLENBOURG

58

My flow

Learning documentation

Main flow

CHILI

DEMO - FLOW

Posts 14 Comments 3

Was ist die Ihr interessantes Defekt?

06.10.2017

Vorgaben Arbeitssicherheit

Organisation der Desinfizierungskette

La greffe

Quelles techniques de greffes pour quelles plantes ? (Horticulteurs)

Was ist Ihr interessantestes Defekt

Joris F 06/29/2017 - DEMO - FLOW

Boîtiers, Raccordements, Mesures, Schémas et travaux réalisés



Les boîtiers sont souvent installés dans une armoire à la cave.

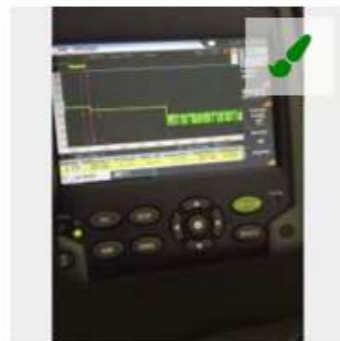

L'appareil de mesure montre un pic qui indique à quelle distance se trouve l'erreur.



Schéma de raccordement

Realto

exempleLD.pdf

- DE_REALTO_Einfuehrung_Berufsbildn...
- FR_REALTO_Intro_Enseignant_Genera...
- DE_REALTO_Einfuehrung_Lehrperson...
- FR_REALTO_intro_Formateur_general...
- FR_REALTO_Introduction_Apprenti_ge...
- DE_REALTO_Einfuehrung_Lernenden...
- CheckListeNeueFunktionalitatenSept2...

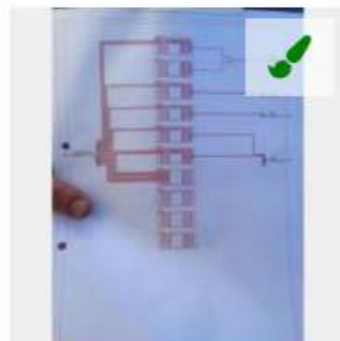
Edit



The « Erfahrungsraum » model

1. Capture workplace experience
2. Exploit it in classroom activities
3. **Expand experience**

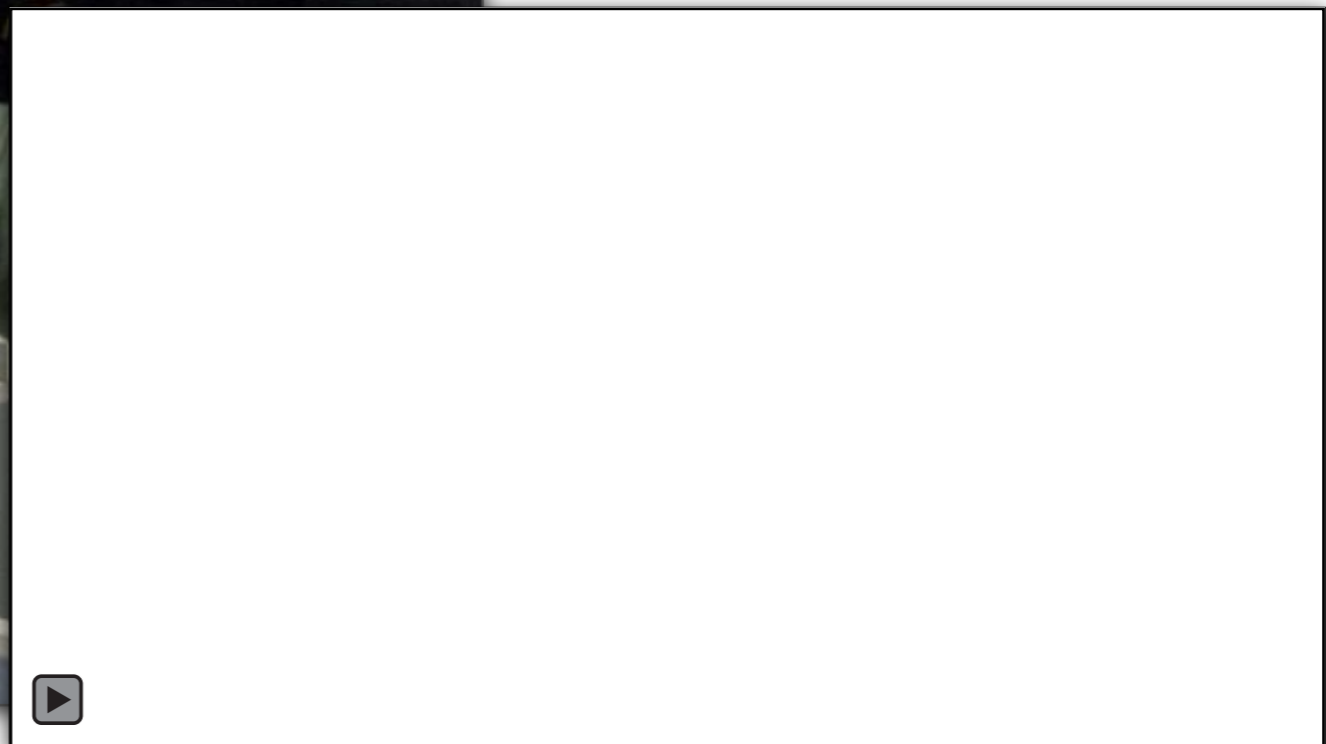
In the real world,
we do **not** move shelves with 2 fingers !



In the real world, we do not see forces !

Axial Forces:  Compression  Tension  Support

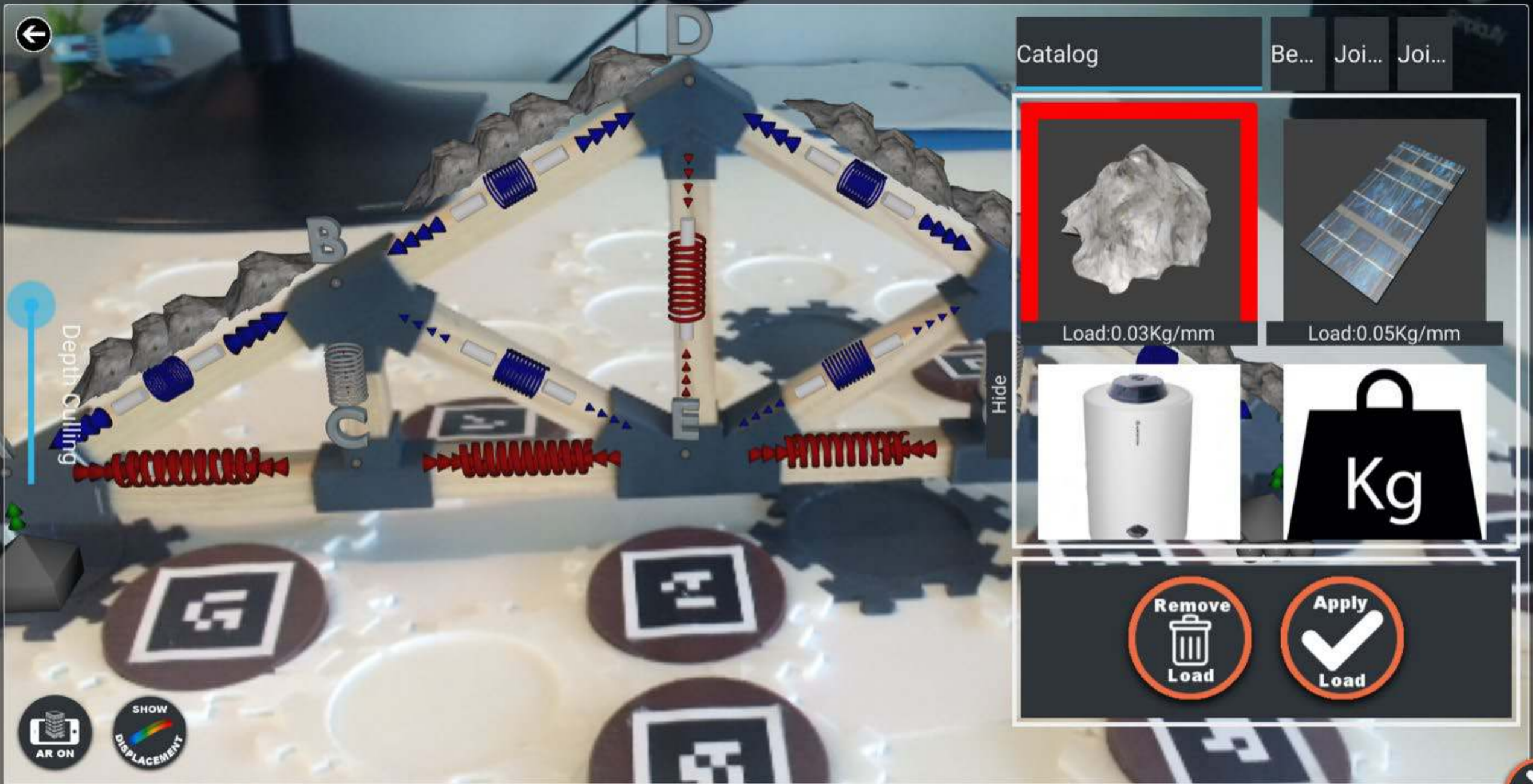

The image shows an AR application interface for a mechanical model. The main view displays a 3D model of a structure with various components and forces. A legend at the top indicates that blue arrows represent Compression, red arrows represent Tension, and green arrows represent Support. The model includes a central vertical rod with a spring, two diagonal rods with springs, and a horizontal base with a spring. A 'Depth Culling' slider is visible on the left. A 'Catalog' panel on the right shows two load options: a crumpled paper ball with a load of 0.03Kg/mm and a rectangular metal plate with a load of 0.05Kg/mm. Below the catalog are icons for a white cylindrical object and a black shopping bag labeled 'Kg'. At the bottom of the catalog panel are 'Remove Load' and 'Apply Load' buttons. The interface also features a back arrow in the top left, a 'SHOW DISPLACEMENT' button, and a right arrow in the bottom right. The number '20' is displayed at the bottom center.

Gouvernance

Regierungsführung

3

Méthodes

Methoden

2

Pédagogie

Pädagogik

Ziele

Objectifs

1

Inhalt

Contenus

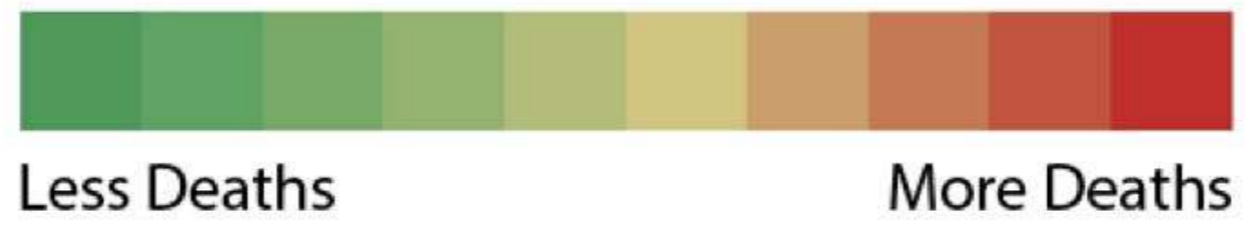
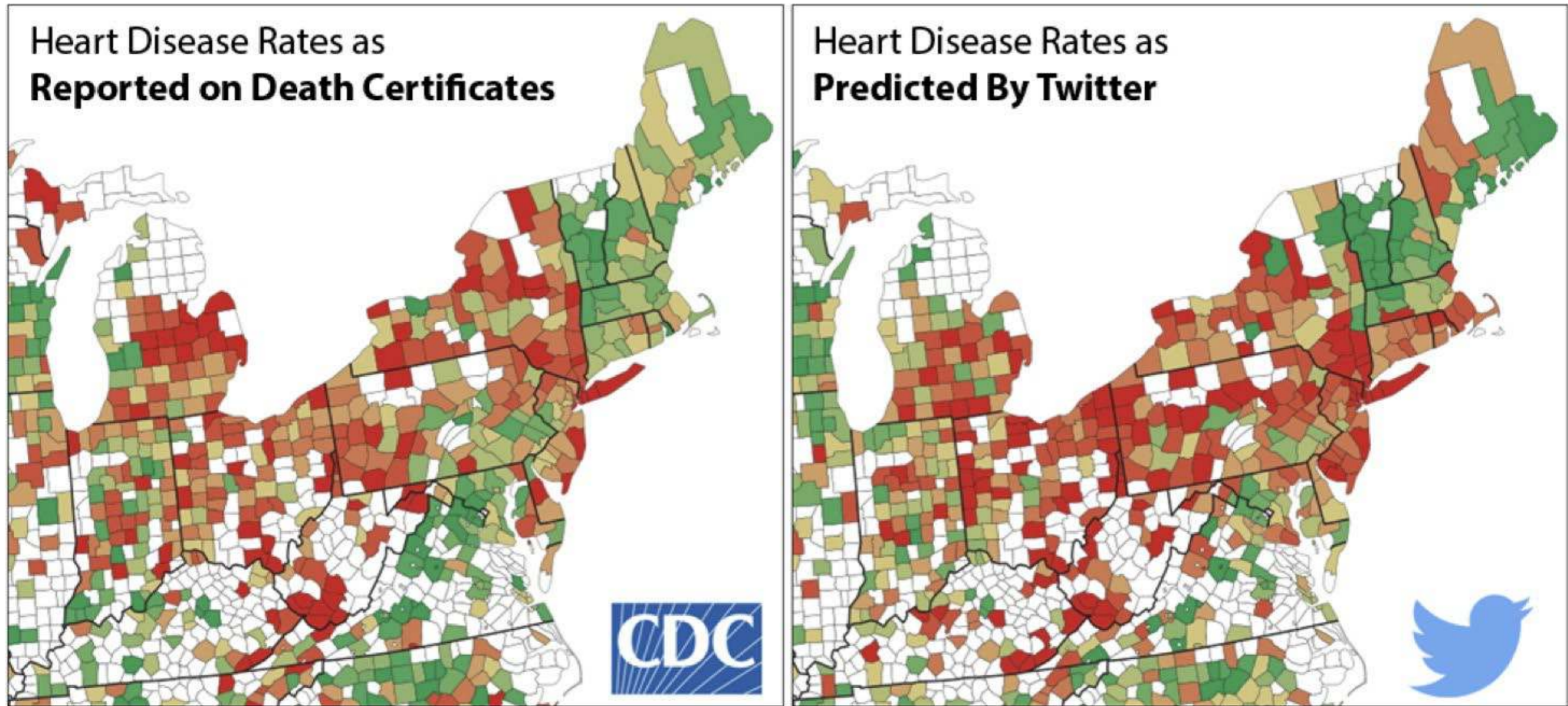

Epidémiologie Digitale / Digitale Epidemiologie

79 star-ups en EdTech



EPFL

JACOBS FOUNDATION
Our Promise to Youth

FONDATION HENRIMOSER



digitalswitzerland

DUAL

CVCube

explore-it



MAT RIX



TOTALYMAGE



CIKUMAS



Classtime

Simulation

the experience accelerator

eSkills



Reallience

testwe

PocketCampus

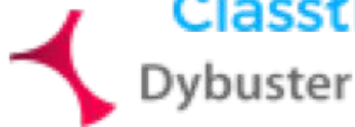

mobsya

Calerga

eSkills



arketiks

hilyte



Klewel

NEOCOSMO

fuel

Little Vista

better study

hilyte



Klewel

SLX

GalliLearn



MOBILE TC

Rosie

MEGAVERSE

AURA

elever



UbiSim

smarttravel

taskbase

bulbee

ayaru

RITA.global

InnovaKeds



KINAPS



isyflow

workseed

proof



InnovaKeds



KINAPS



we are play lab



LANTERN.ch

Simpliquity



GOODWALL

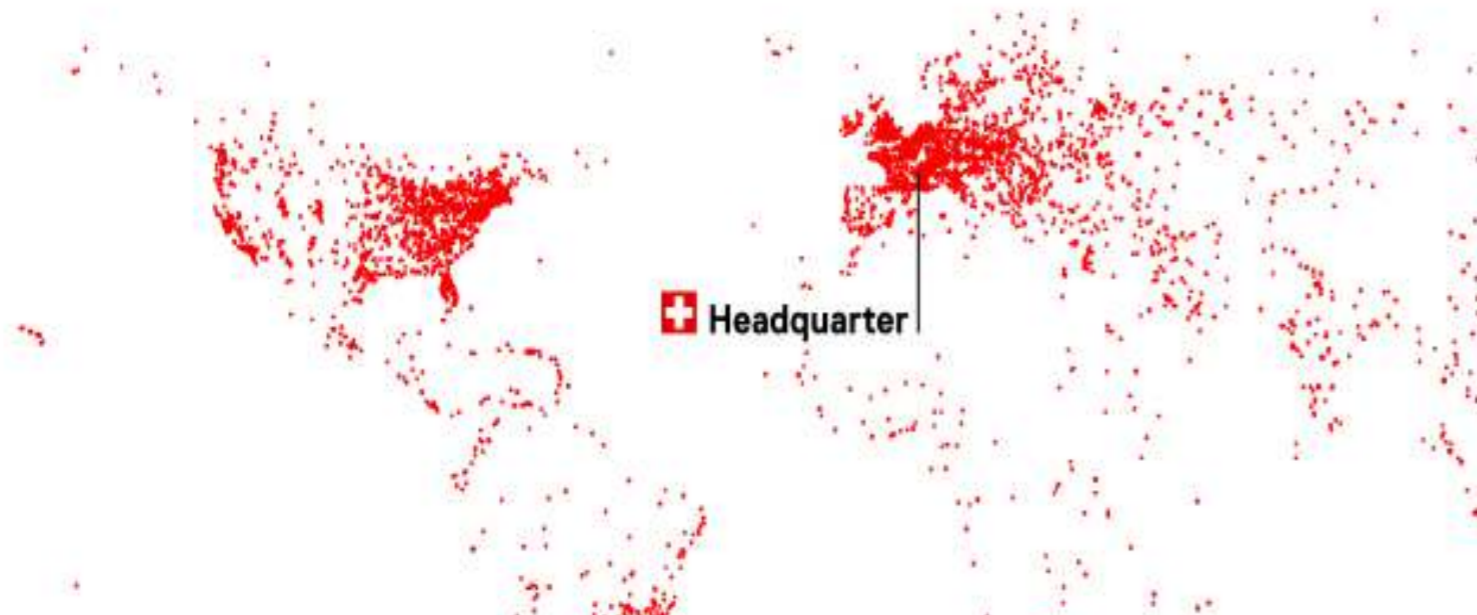

EPFL Center for Learning Sciences

© EPFL CEAT/CEDE, 2014, J. Chenal, M. Bonriposi, P. Jermann

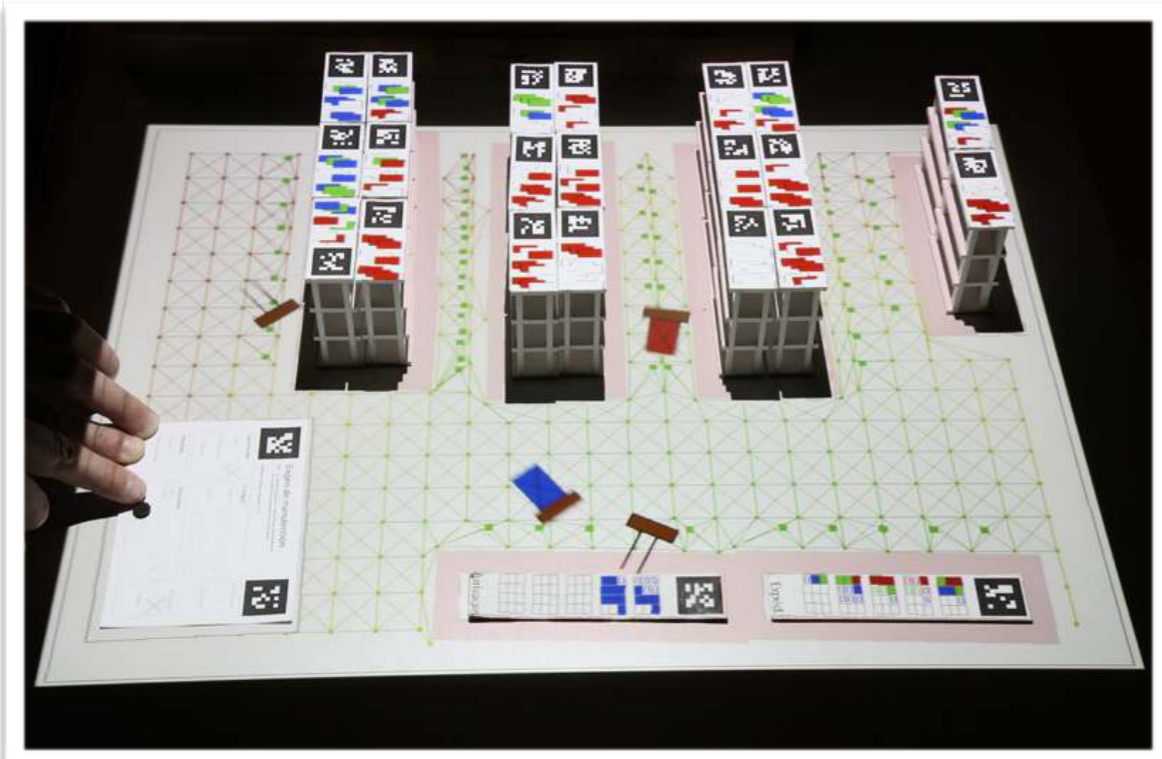

digitalswitzerland

SWISS

EdTech Collider

FONDATION HENRIMOSER

JACOBS FOUNDATION
Our Promise to Youth

Dybuster, TOTALMAGE, coopacademy, we are play lab, K'lewel, GOODWALL, NEOCOSMO, PocketCampus, Calerga, better study, EKSTRA REALITY, LANTERN, LEARNING SEVEN, MAT RIX, mobsya, headswap, LANTERN, tthf, Happy Numbers, GallLearn, MOBILE TC, taskbase, UbiSim, ROSIE, LABSTER, lillup, Simplicuity, Keds, educabay, Little Vista, LEDsafari, Test We., SpeakUP, ayaru, IDEAO, SLX, GRAASP, bulbee, Si, EPFL EXTENSION CENTRE